

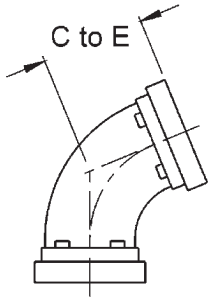

Grooved End Fittings - Series 45

Series 45



Features:

- designed to provide minimum pressure drop and uniform strength
- maximum operating pressure: **500 PSI** at ambient temperature **70°F (21°C)**
- ductile iron body with rust inhibiting paint
- Underwriters Listed and Factory Mutual approved
- Comparable to:
Victaulic's #110
Grinnell's #7051

Nominal Size	Dimensions C to E	Ductile Iron Part #
2"	2"	L2045
2½"	2¼"	L2545
3"	2½"	L3045
4"	3"	L4045
5"	3¼"	L5145
6"	3½"	L6045
8"	4¼"	L8045



Series 90

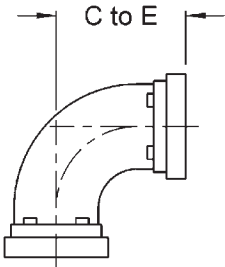

Features:

- designed to provide minimum pressure drop and uniform strength
- maximum operating pressure: **500 PSI** at ambient temperature **70°F (21°C)**
- ductile iron body with rust inhibiting paint
- Underwriters Listed and Factory Mutual approved
- Comparable to:
Victaulic's #10
Grinnell's #7050

Nominal Size	Dimensions C to E	Ductile Iron Part #
2"	3¼"	L502
2½"	3¾"	L5025
3"	4¼"	L503
4"	5"	L504
6"	6½"	L506
8"	7¾"	L508



Series T

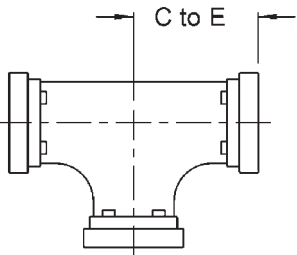

Features:

- designed to provide minimum pressure drop and uniform strength
- maximum operating pressure: **500 PSI** at ambient temperature **70°F (21°C)**
- ductile iron body with rust inhibiting paint
- Underwriters Listed and Factory Mutual approved
- Comparable to:
Victaulic's #20
Grinnell's #7060

Nominal Size	Dimensions C to E	Ductile Iron Part #
2"	3¼"	T602
2½"	3¾"	T6025
3"	4¼"	T603
4"	5"	T604
6"	6½"	T606
8"	7¾"	T608